

## Guide post 03

Guide post according to DIN 9833

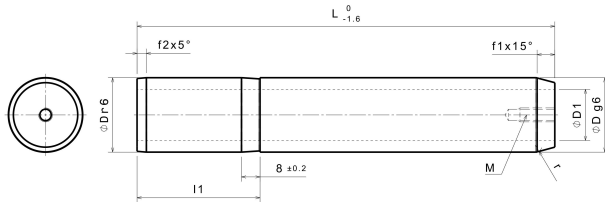

### Product description:

Guide post according to DIN 9833

### Article properties:

Base Material	Steel, hardened
Hardening depth	1 + 0,5 mm
Hardness	58 ± 2 HRC

### Variants:

Articlenumber	Article name	Outer Ø D	Length L	D1	l1	f1	f2	r	M
833251255	03 25-125	25	125	-	40	8	4	3	-
833251405	03 25-140	25	140	-	40	8	4	3	-
833251605	03 25-160	25	160	-	40	8	4	3	-
833251805	03 25-180	25	180	-	40	8	4	3	-
833321405	03 32-140	32	140	-	45	8	4	3	-
833321605	03 32-160	32	160	-	45	8	4	3	-
833321805	03 32-180	32	180	-	45	8	4	3	-
833322005	03 32-200	32	200	-	45	8	4	3	-
833401405	03 40-140	40	140	-	56	8	4	3	-
833401605	03 40-160	40	160	-	56	8	4	3	-
833401805	03 40-180	40	180	-	56	8	4	3	-
833402005	03 40-200	40	200	-	56	8	4	3	-
833402245	03 40-224	40	224	-	56	8	4	3	-
833402505	03 40-250	40	250	-	56	8	4	3	-
833402805	03 40-280	40	280	-	56	8	4	3	-
833501605	03 50-160	50	160	-	70	10	4	5	-
833501805	03 50-180	50	180	-	70	10	4	5	-
833502005	03 50-200	50	200	-	70	10	4	5	-
833502245	03 50-224	50	224	-	70	10	4	5	-
833502505	03 50-250	50	250	-	70	10	4	5	-
833502805	03 50-280	50	280	-	70	10	4	5	-
833503155	03 50-315	50	315	-	70	10	4	5	-
833503555	03 50-355	50	355	-	70	10	4	5	-
833631805	03 63-180	63	180	-	80	10	4	6	-
833632005	03 63-200	63	200	-	80	10	4	6	-
833632245	03 63-224	63	224	-	80	10	4	6	-

## Guide post 03

Guide post according to DIN 9833



Articlenumber	Article name	Outer Ø D	Length L	D1	l1	f1	f2	r	M
833632505	03 63-250	63	250	-	80	10	4	6	-
833632805	03 63-280	63	280	-	80	10	4	6	-
833633155	03 63-315	63	315	-	80	10	4	6	-
833633555	03 63-355	63	355	-	80	10	4	6	-
833634005	03 63-400	63	400	-	80	10	4	6	-
833802245	03 80-224	80	224	-	100	10	4	8	M12x24
833802505	03 80-250	80	250	-	100	10	4	8	M12x24
833802805	03 80-280	80	280	-	100	10	4	8	M12x24
833803155	03 80-315	80	315	-	100	10	4	8	M12x24
833803555	03 80-355	80	355	-	100	10	4	8	M12x24
833804005	03 80-400	80	400	-	100	10	4	8	M12x24
8338022450	03 80-224 H	80	224	40	100	10	4	8	-
8338025050	03 80-250 H	80	250	40	100	10	4	8	-
8338028050	03 80-280 H	80	280	40	100	10	4	8	-
8338031550	03 80-315 H	80	315	40	100	10	4	8	-
8338035550	03 80-355 H	80	355	40	100	10	4	8	-
8338040050	03 80-400 H	80	400	40	100	10	4	8	-
833102805	03 100-280	100	280	-	125	10	4	10	M12x24
833103155	03 100-315	100	315	-	125	10	4	10	M12x24
833103555	03 100-355	100	355	-	125	10	4	10	M12x24
833104005	03 100-400	100	400	-	125	10	4	10	M12x24
8331028050	03 100-280 H	100	280	50	125	10	4	10	-
8331031550	03 100-315 H	100	315	50	125	10	4	10	-
8331035550	03 100-355 H	100	355	50	125	10	4	10	-
8331040050	03 100-400 H	100	400	50	125	10	4	10	-
831253155	03 125-315	125	315	-	140	12	5	12	M12x24
831253555	03 125-355	125	355	-	140	12	5	12	M12x24
831254005	03 125-400	125	400	-	140	12	5	12	M12x24
831254505	03 125-450	125	450	-	140	12	5	12	M12x24
831255005	03 125-500	125	500	-	140	12	5	12	M12x24
8312531550	03 125-315 H	125	315	65	140	12	5	12	-
8312535550	03 125-355 H	125	355	65	140	12	5	12	-
8312540050	03 125-400 H	125	400	65	140	12	5	12	-
8312545050	03 125-450 H	125	450	65	140	12	5	12	-
8312550050	03 125-500 H	125	500	65	140	12	5	12	-
831604005	03 160-400	160	400	-	180	12	5	18	M12x24
831604505	03 160-450	160	450	-	180	12	5	18	M12x24
831605005	03 160-500	160	500	-	180	12	5	18	M12x24
831605605	03 160-560	160	560	-	180	12	5	18	M12x24
8316040050	03 160-400 H	160	400	95	180	12	5	18	-
8316045050	03 160-450 H	160	450	95	180	12	5	18	-
8316050050	03 160-500 H	160	500	95	180	12	5	18	-
8316056050	03 160-560 H	160	560	95	180	12	5	18	-